

ELEVATION

SEE DETAIL A
 RWM02a w/ RWB01a BACKUP PLATE
 FBX08a x 1.5 [40] LNG BOLT & 2 NUTS w/ 2 FWR01 WASHERS & 1 ROUND WASHER

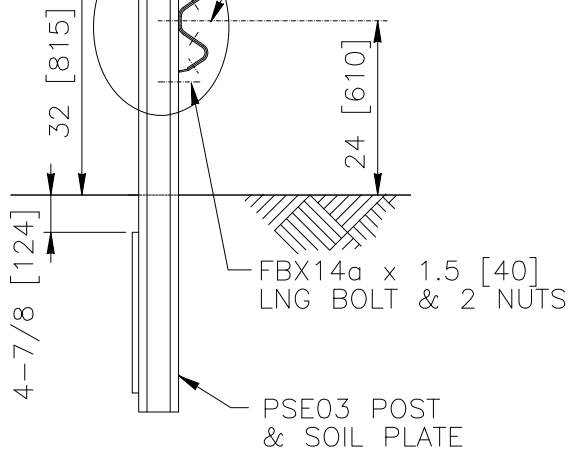

SECTION

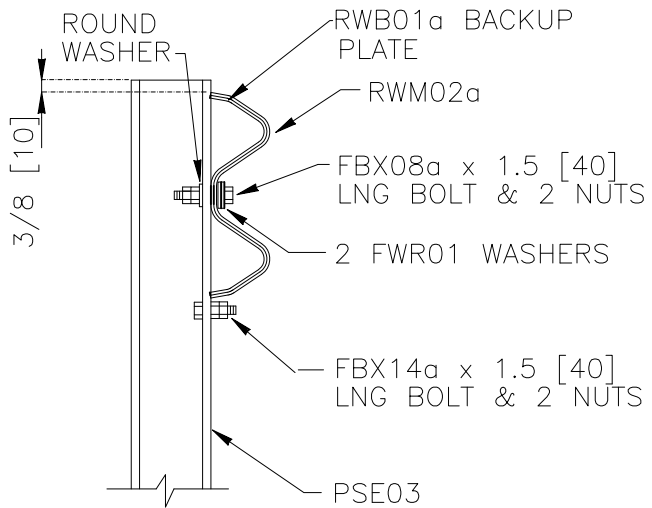

DETAIL A: RAIL-POST ATTACHMENT

2005

WEAK-POST W-BEAM GUARDRAIL



SGR02b

SHEET NO.	DATE:
1 of 2	7/20/2005

INTENDED USE

Weak-post W-beam guardrails are commonly used where dynamic deflections of at least 87 inches [2200 mm] are acceptable. This system must be anchored with a suitable terminal system; crashworthy W-beam terminals can be transitioned to and used with this guardrail system. SGR-02b is a Test Level 3 barrier.

COMPONENTS

Unit length = 150 inches [3810 mm]

Designator	Component	Number
FBB01	Splice bolts and nuts	8
FBX08a	Rail-post bolt (1.5 [40]) and nut	1
FBX14a	Rail support bolt (1.5 [40]) and nut	1
FWR01	Guardrail washer	1
PSE03	Post	1
RWB01a	W-beam back-up plate	1
RWM02a	W-beam rail	1

APPROVALS

FHWA Acceptance Letter B-64A.

REFERENCES

M.H. Ray, K. Engstrand, C.A. Plaxico, and R.G. McGinnis, "Improvements to the Weak-Post W-Beam Guardrail," *Transportation Research Record 1743*, pp. 88-96, 2001.

M.E. Bronstad, J.E. Michie and J.D. Mayer, Jr., *Performance of Longitudinal Traffic Barriers*, National Cooperative Highway Research Program Report Number 289, Transportation Research Board, June, 1987.

J.D. Michie, L.R. Calcote, and M.E. Bronstad, *Guardrail Performance and Design*, National Cooperative Highway Research Program Report Number 115, Highway Research Board, 1971.

CONTACT INFORMATION

Federal Highway Administration
Office of Safety
400 Seventh Street, SW
Washington, DC 20590
202-366-2288

WEAK-POST W-BEAM GUARDRAIL

SGR02b

SHEET NO.

DATE

2 of 2

07/20/2005

